



Model: **JF**



Conforms to EN ISO3691-5  
Based on Directive 2006/42/EC

- Ideal design with numerous possibilities makes this unit very suitable as pallet truck/scissor lift table.
- Telescopic jack composes of 3 piston rods creating light pumping force giving great rigidity.
- Support legs come into operation automatically.
- It prevents the unit from moving when the forks are raised to keep the safety of the operator.
- Truck automatically slows the descending speed when heavy goods loaded to prevent cargo damage.
- 210 degree turning radius.
- 2 lateral stabilizers when raised ensure good stability.

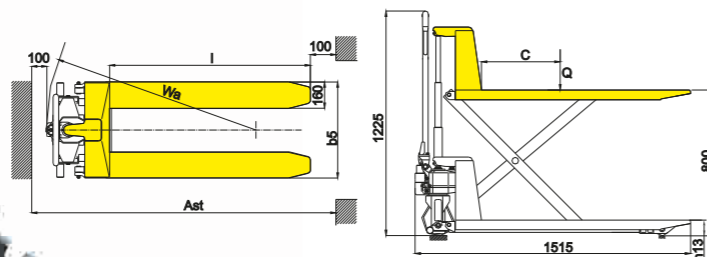

1KG=2.205LB    1INCH=25.40MM

| Model                                       |                     | JF                   | JF7                  |
|---|---------------------|----------------------|----------------------|
| Capacity                                    | Q(kg)               | 1000                 | 1000                 |
| Lowered fork height                         | $h_{\text{L}}$ (mm) | 85                   | 85                   |
| Steering wheel                              | mm                  | $\Phi 180 \times 50$ | $\Phi 180 \times 50$ |
| Fork wheel                                  | mm                  | $\Phi 74 \times 50$  | $\Phi 74 \times 50$  |
| Fork length                                 | $l$ (mm)            | 1150                 | 1220                 |
| Width overall forks                         | $b_{\text{f}}$ (mm) | 520/550/685          | 550/685              |
| Aisle width for pallets 1000x1200 crossways | $A_{\text{c}}$ (mm) | 1715                 | 1985                 |
| Aisle width for pallets 800x1200 lengthways | $A_{\text{L}}$ (mm) | 1765                 | 1985                 |
| Turning radius                              | $W_{\text{t}}$ (mm) | 1360                 | 1670                 |
| Service weight                              | kg                  | 104-115              | 104-115              |

Model: **JF7**

- Improved safety: Automatic activation of self adjusting stabilizers when lifting loads higher than 400 mm for maximum stability .
- Great stability: Extra long front legs increase the stability when handling unevenly loaded pallets.
- Quick-lift operation: Quick-lift function doubles the lifting speed when lifting loads less than 250kg.

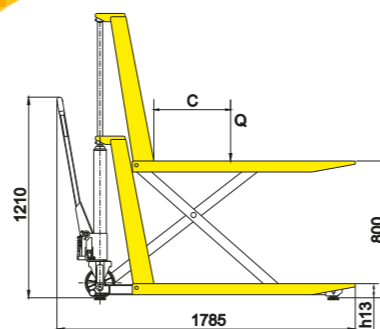
Model: **JFD8**

**Conforms to EN ISO3691-1  
EN1175-1  
EN16307-1  
Based on Directive 2006/42/EC**

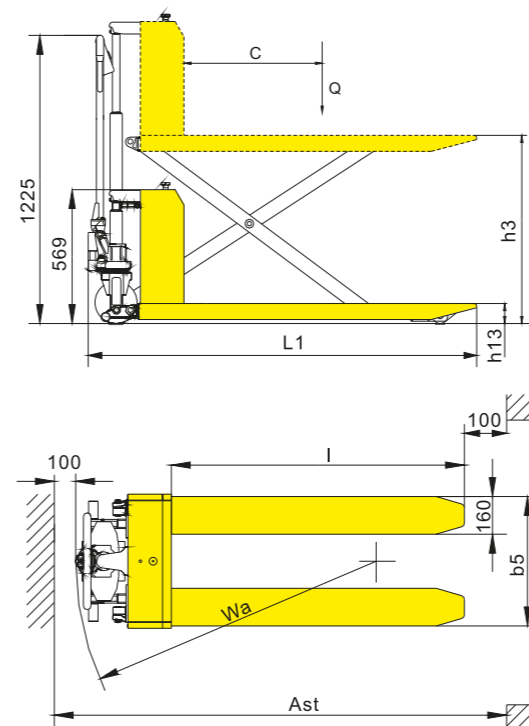

1KG=2.205LB    1INCH=25.40MM

| Model                                       |               | JFD8          |
|---|---------------|---------------|
| Capacity                                    | Q(kg)         | 1000          |
| Lowered fork height                         | $h_{13}$ (mm) | 85            |
| Steering wheel                              | mm            | $\Phi$ 180x50 |
| Fork wheel                                  | mm            | $\Phi$ 74x50  |
| Max. lift height                            | $h_0$ (mm)    | 800           |
| Overall length                              | $L_1$ (mm)    | 1652          |
| Fork length                                 | $l$ (mm)      | 1245          |
| Width overall forks                         | $b_3$ (mm)    | 550/685       |
| Aisle width for pallets 1000x1200 crossways | $A_{w1}$ (mm) | 1852          |
| Aisle width for pallets 800x1200 lengthways | $A_{w2}$ (mm) | 1852          |
| Turning radius                              | $W_4$ (mm)    | 1480          |
| Lift motor rating at S3 15%                 | kW            | 0.7           |
| Battery voltage,nominal capacity K10        | V/Ah          | 12/100        |
| Battery weight                              | kg            | 31            |
| Service weight (with battery)               | kg            | 181           |